

FIELD ELEV. 1100'

(18Y)

MILACA

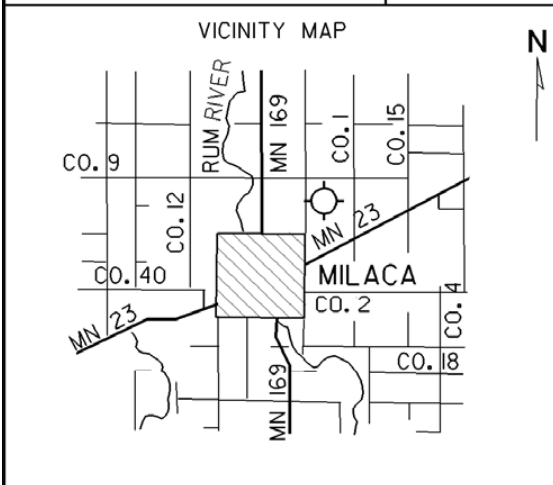

N

SEC. CH: TWIN CITIES (S)

LAT: 45° 46.4'

LONG: 93° 37.9'

COMM: CTAF: 122.9

MPLS CTR: 121.05

RNAV: (STC 112.1) R053 D22.4

TPA: 1900' (800')

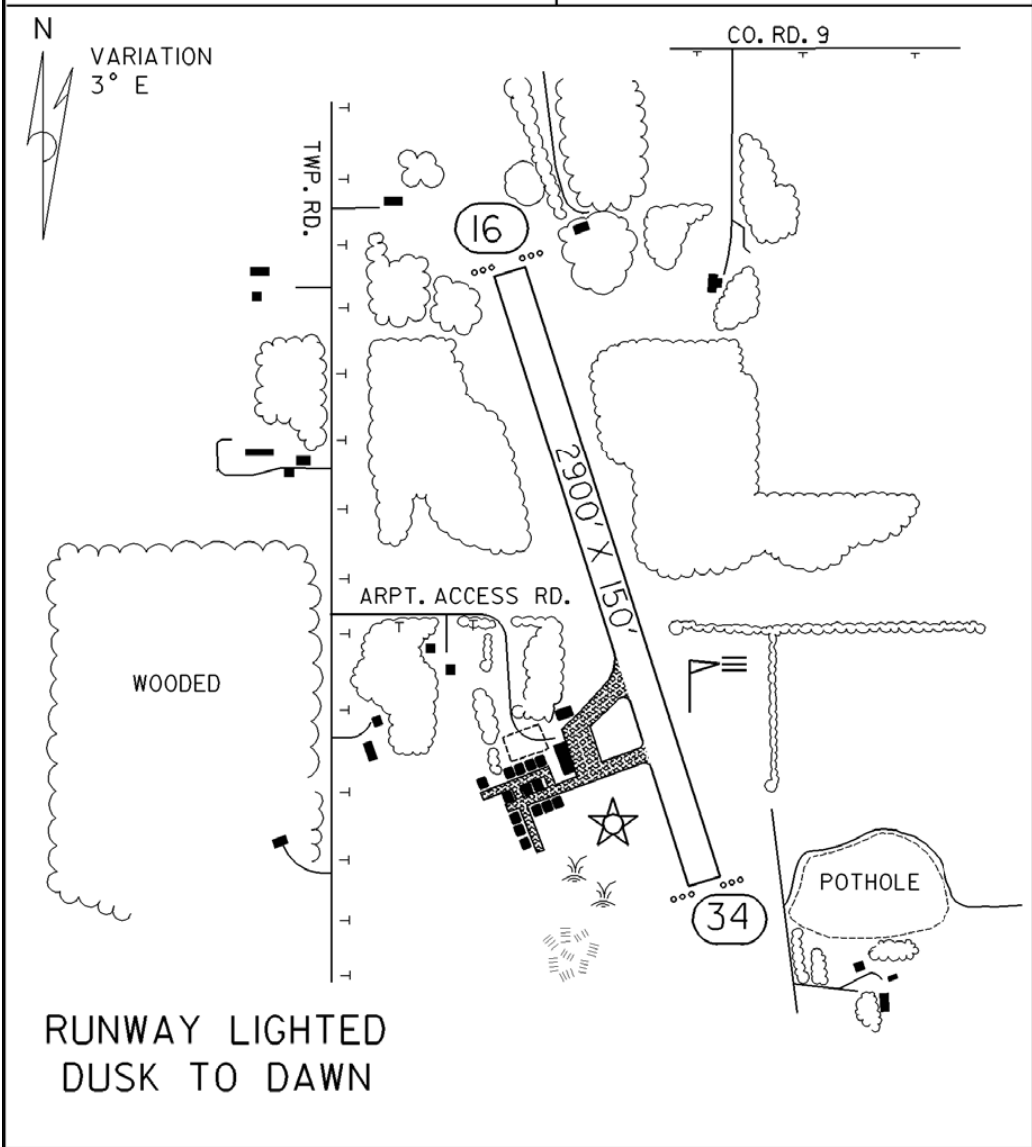

MILACA MUNICIPAL AIRPORT

MILACA